



Butterfly valve type 567 ABS Reduction gear with handwheel



Model:

- Connecting dimension: ISO 7005 PN 10, EN 1092 PN 10, DIN 2501 PN 10, ANSI/ASME B 16.5 Class 150, BS 1560: 1989, BS 4504, JIS B 2220
- Overall length according to EN 558-1, ISO 5752

* Available on request

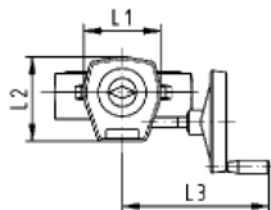
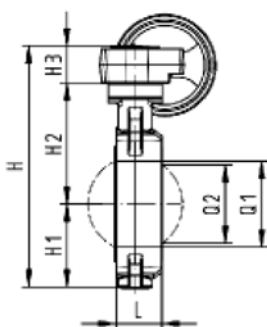
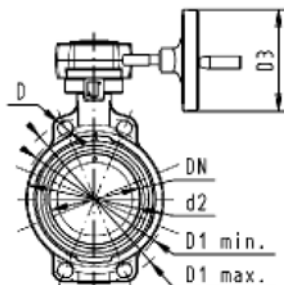

d [mm]	DN [mm]	Inch	PN	kv-value ($\Delta p=1$ bar) [l/min]	EPDM Code
*63	50	2	10	1470	169 567 022
*75	65	2 ½	10	2200	169 567 023
90	80	3	10	3000	169 567 024
110	100	4	10	6500	169 567 025
*140	125	5	10	11500	169 567 026
160	150	6	10	16600	169 567 027
225	200	8	10	39600	169 567 028

d [mm]	D [mm]	D1 min. [mm]	D1 max. [mm]	d2 [mm]	D3 [mm]	H [mm]	H1 [mm]	H2 [mm]	H3 [mm]	L [mm]	L1 [mm]	L2 [mm]	L3 [mm]
*63	19	120.0	125.0	104	160	278	77	134	60	45	120	132	236
*75	19	139.7	145.0	115	160	291	83	140	60	46	120	132	236
90	19	150.0	160.0	131	160	303	89	146	60	49	120	132	236
110	19	175.0	190.5	160	160	339	104	167	60	56	120	132	236
*140	23	210.0	215.9	187	160	365	117	181	60	64	120	132	236
160	24	241.3	241.3	215	160	387	130	189	60	72	120	132	236
225	23	290.0	295.0	267	160	436	158	210	60	73	120	132	236

d [mm]	Q1 [mm]	Q2 [mm]
*63	40	
*75	54	35
90	67	50
110	88	74
*140	113	97
160	139	123
225	178	169

Butterfly valves electric ABS

Butterfly valve type 140 ABS 100-230V Without manual override



Model:

- Connecting dimension: ISO 7005 PN 10, EN 1092 PN 10, DIN 2501 PN 10, ANSI/ASME B 16.5 Class 150, BS 1560: 1989, BS 4504, JIS B 2220
- Overall length according to EN 558-1, ISO 5752
- Voltage 100-230 V, 50-60 Hz
- Control time 15 s/90°<) EA31
- Control time 25s/90°<) EA42
- Control range 90°<)
- Actuator with integrated emergency manual override standard

* Available on request

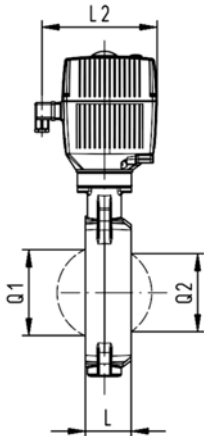
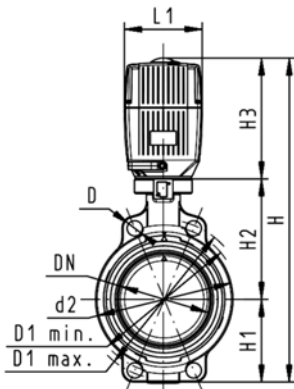

d [mm]	DN [mm]	Inch	PN	kv-value ($\Delta p=1$ bar) [l/min]	EPDM Code
*63	50	2	10	1470	199 140 502
*75	65	2 ½	10	2200	199 140 503
90	80	3	10	3000	199 140 504
110	100	4	10	6500	199 140 505
*140	125	5	10	11500	199 140 506
160	150	6	10	16600	199 140 507
225	200	8	10	39600	199 140 508

d [mm]	Actuator unit type	D [mm]	D1 min. [mm]	D1 max. [mm]	d2 [mm]	H [mm]	H1 [mm]	H2 [mm]	H3 [mm]	L [mm]	L1 [mm]	L2 [mm]
*63	EA-31	19	120.0	125.0	104	400	77	134	188	45	122	180
*75	EA-31	19	139.7	145.0	115	413	83	140	188	46	122	180
90	EA-31	19	150.0	160.0	131	428	89	146	188	49	122	180
110	EA-31	19	175.0	190.5	161	460	104	167	188	56	122	180
*140	EA-31	23	210.0	215.9	187	487	117	181	188	64	122	180
160	EA-31	24	241.3	241.3	215	508	130	189	188	72	122	180
225	EA-42	23	290.0	295.0	267	575	158	210	208	73	122	180

d [mm]	Q1 [mm]	Q2 [mm]
*63	40	
*75	54	35
90	67	50
110	88	74
*140	113	97
160	139	123
225	178	169



Butterfly valve type 140 ABS 100-230V With manual override



Model:

- Connecting dimension: ISO 7005 PN 10, EN 1092 PN 10, DIN 2501 PN 10, ANSI/ASME B 16.5 Class 150, BS 1560: 1989, BS 4504, JIS B 2220
- Overall length according to EN 558-1, ISO 5752
- Voltage 100-230 V, 50-60 Hz
- Control time 15 s/90°<) EA31
- Control time 25s/90°<) EA42
- Control range 90°<)
- Actuator with integrated emergency manual override standard

* Available on request

d [mm]	DN [mm]	Inch	PN	kv-value ($\Delta p=1$ bar) [l/min]	EPDM Code
*63	50	2	10	1470	199 140 482
*75	65	2 ½	10	2200	199 140 483
90	80	3	10	3000	199 140 484
110	100	4	10	6500	199 140 485
*140	125	5	10	11500	199 140 486
160	150	6	10	16600	199 140 487
225	200	8	10	39600	199 140 488

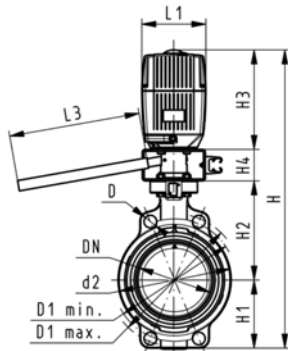

d [mm]	Actuator unit type	D [mm]	D1 min. [mm]	D1 max. [mm]	d2 [mm]	H [mm]	H1 [mm]	H2 [mm]	H3 [mm]	H4 [mm]	L [mm]	L1 [mm]
*63	EA-31	19	120.0	125.0	104	460	77	134	188	60	45	122
*75	EA-31	19	139.7	145.0	115	473	83	140	188	60	46	122
90	EA-31	19	150.0	160.0	131	488	89	146	188	60	49	122
110	EA-31	19	175.0	190.5	161	520	104	167	188	60	56	122
*140	EA-31	23	210.0	215.9	187	547	117	181	188	60	64	122
160	EA-31	24	241.3	241.3	215	568	130	189	188	60	72	122
225	EA-42	23	290.0	295.0	267	635	158	210	208	60	73	122

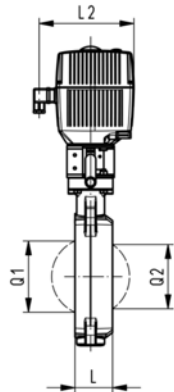

d [mm]	L2 [mm]	L3 [mm]	Q1 [mm]	Q2 [mm]
*63	180	250	40	
*75	180	250	54	35
90	180	250	67	50
110	180	250	88	74
*140	180	250	113	97
160	180	250	139	123
225	180	250	178	169



Butterfly valve type 140 ABS 24V Without manual override



Model:

- Connecting dimension: ISO 7005 PN 10, EN 1092 PN 10, DIN 2501 PN 10, ANSI/ASME B 16.5 Class 150, BS 1560: 1989, BS 4504, JIS B 2220
- Overall length according to EN 558-1, ISO 5752
- Voltage 24 V AC/DC
- Control time 15 s/90°<) EA31
- Control time 25s/90°<) EA42
- Control range 90°<)
- Actuator with integrated emergency manual override standard

* Available on request

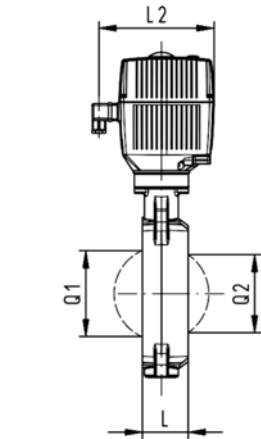
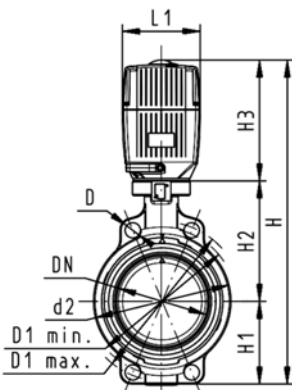

d [mm]	DN [mm]	Inch	PN	kv-value ($\Delta p=1$ bar) [l/min]	EPDM Code
*63	50	2	10	1470	199 140 542
*75	65	2 ½	10	2200	199 140 543
90	80	3	10	3000	199 140 544
110	100	4	10	6500	199 140 545
*140	125	5	10	11500	199 140 546
160	150	6	10	16600	199 140 547
225	200	8	10	39600	199 140 548

d [mm]	Actuator unit type	D [mm]	D1 min. [mm]	D1 max. [mm]	d2 [mm]	H [mm]	H1 [mm]	H2 [mm]	H3 [mm]	L [mm]	L1 [mm]	L2 [mm]
*63	EA-31	19	120.0	125.0	104	400	77	134	188	45	122	180
*75	EA-31	19	139.7	145.0	115	413	83	140	188	46	122	180
90	EA-31	19	150.0	160.0	131	428	89	146	188	49	122	180
110	EA-31	19	175.0	190.5	161	460	104	167	188	56	122	180
*140	EA-31	23	210.0	215.9	187	487	117	181	188	64	122	180
160	EA-31	24	241.3	241.3	215	508	130	189	188	72	122	180
225	EA-42	23	290.0	295.0	267	575	158	210	208	73	122	180

d [mm]	Q1 [mm]	Q2 [mm]
*63	40	
*75	54	35
90	67	50
110	88	74
*140	113	97
160	139	123
225	178	169



Butterfly valve type 140 ABS 24V With manual override



Model:

- Connecting dimension: ISO 7005 PN 10, EN 1092 PN 10, DIN 2501 PN 10, ANSI/ASME B 16.5 Class 150, BS 1560: 1989, BS 4504, JIS B 2220
- Overall length according to EN 558-1, ISO 5752
- Voltage 24 V AC/DC
- Control time 15 s/90°<) EA31
- Control time 25s/90°<) EA42
- Control range 90°<)
- Actuator with integrated emergency manual override standard

* Available on request

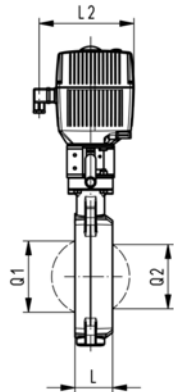
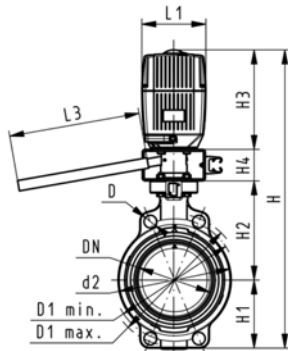

d [mm]	DN [mm]	Inch	PN	kv-value ($\Delta p=1$ bar) [l/min]	EPDM Code
*63	50	2	10	1470	199 140 522
*75	65	2 ½	10	2200	199 140 523
90	80	3	10	3000	199 140 524
110	100	4	10	6500	199 140 525
*140	125	5	10	11500	199 140 526
160	150	6	10	16600	199 140 527
225	200	8	10	39600	199 140 528

d [mm]	Actuator unit type	D [mm]	D1 min. [mm]	D1 max. [mm]	d2 [mm]	H [mm]	H1 [mm]	H2 [mm]	H3 [mm]	H4 [mm]	L [mm]	L1 [mm]
*63	EA-31	19	120.0	125.0	104	460	77	134	188	60	45	122
*75	EA-31	19	139.7	145.0	115	473	83	140	188	60	46	122
90	EA-31	19	150.0	160.0	131	488	89	146	188	60	49	122
110	EA-31	19	175.0	190.5	161	520	104	167	188	60	56	122
*140	EA-31	23	210.0	215.9	187	547	117	181	188	60	64	122
160	EA-31	24	241.3	241.3	215	568	130	189	188	60	72	122
225	EA-42	23	290.0	295.0	267	635	158	210	208	60	73	122

d [mm]	L2 [mm]	L3 [mm]	Q1 [mm]	Q2 [mm]
*63	180	250	40	
*75	180	250	54	35
90	180	250	67	50
110	180	250	88	74
*140	180	250	113	97
160	180	250	139	123
225	180	250	178	169

Butterfly valves pneumatic ABS

Butterfly valve type 240 ABS FC (Fail safe to close) Without manual override

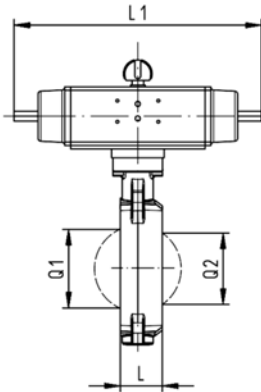
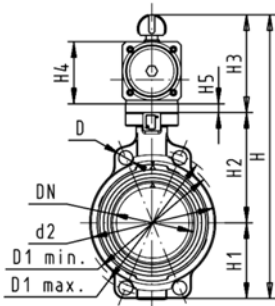

Model:

- Connecting dimension: ISO 7005 PN 10, EN 1092 PN 10, DIN 2501 PN 10, ANSI/ASME B 16.5 Class 150, BS 1560: 1989, BS 4504, JIS B 2220
- Overall length according to EN 558-1, ISO 5752
- Control range 90°<

* Available on request

d [mm]	DN [mm]	Inch	PN	kv-value ($\Delta p=1$ bar) [l/min]	EPDM Code
*63	50	2	10	1470	199 240 402
*75	65	2 ½	10	2200	199 240 403
90	80	3	10	3000	199 240 404
110	100	4	10	6500	199 240 405
*140	125	5	10	11500	199 240 406
160	150	6	10	16600	199 240 407
225	200	8	10	39600	199 240 408

d [mm]	Actuator unit type	D [mm]	D1 min. [mm]	D1 max. [mm]	d2 [mm]	H [mm]	H1 [mm]	H2 [mm]	H3 [mm]	H4 [mm]	H5 [mm]	L [mm]
*63	PA-30 FC	19	120.0	125.0	104	327	77	134	117	70	15	45
*75	PA-30 FC	19	139.7	145.0	115	340	83	140	117	70	15	46
90	PA-35 FC	19	150.0	160.0	131	361	89	146	126	78	15	49
110	PA-40 FC	19	175.0	190.5	161	400	104	167	129	86		56
*140	PA-45 FC	23	210.0	215.9	187	436	117	181	139	96		64
160	PA-50 FC	24	241.3	241.3	215	468	130	189	149	106		72
225	PA-55 FC	23	290.0	295.0	267	529	158	210	161	118		73

d [mm]	L1 [mm]	L2 [mm]	Q1 [mm]	Q2 [mm]
*63	276	65	40	
*75	276	65	54	35
90	326	72	67	50
110	370	80	88	74
*140	411	90	113	97
160	423	100	139	123
225	452	112	178	169



Butterfly valve type 240 ABS FO (Fail safe to open) Without manual override



Model:

- Connecting dimension: ISO 7005 PN 10, EN 1092 PN 10, DIN 2501 PN 10, ANSI/ASME B 16.5 Class 150, BS 1560: 1989, BS 4504, JIS B 2220
- Overall length according to EN 558-1, ISO 5752
- Control range 90°<

* Available on request

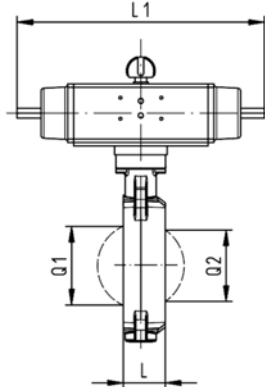
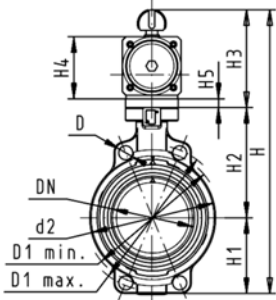

d [mm]	DN [mm]	Inch	PN	kv-value ($\Delta p=1$ bar) [l/min]	EPDM Code
*63	50	2	10	1470	199 240 422
*75	65	2 1/2	10	2200	199 240 423
90	80	3	10	3000	199 240 424
110	100	4	10	6500	199 240 425
*140	125	5	10	11500	199 240 426
160	150	6	10	16600	199 240 427
225	200	8	10	39600	199 240 428

d [mm]	Actuator unit type	D [mm]	D1 min. [mm]	D1 max. [mm]	d2 [mm]	H [mm]	H1 [mm]	H2 [mm]	H3 [mm]	H4 [mm]	H5 [mm]	L [mm]
*63	PA-30 FO	19	120.0	125.0	104	327	77	134	117	70	15	45
*75	PA-30 FO	19	139.7	145.0	115	340	83	140	117	70	15	46
90	PA-35 FO	19	150.0	160.0	131	361	89	146	126	78	15	49
110	PA-40 FO	19	175.0	190.5	161	400	104	167	129	86		56
*140	PA-45 FO	23	210.0	215.9	187	436	117	181	139	96		64
160	PA-50 FO	24	241.3	241.3	215	468	130	189	149	106		72
225	PA-55 FO	23	290.0	295.0	267	529	158	210	161	118		73

d [mm]	L1 [mm]	L2 [mm]	Q1 [mm]	Q2 [mm]
*63	276	65	40	
*75	276	65	54	35
90	326	72	67	50
110	370	80	88	74
*140	411	90	113	97
160	423	100	139	123
225	452	112	178	169



Butterfly valve type 240 ABS DA (Double acting) Without manual override



Model:

- Connecting dimension: ISO 7005 PN 10, EN 1092 PN 10, DIN 2501 PN 10, ANSI/ASME B 16.5 Class 150, BS 1560: 1989, BS 4504, JIS B 2220
- Overall length according to EN 558-1, ISO 5752
- Control range 90°<

* Available on request

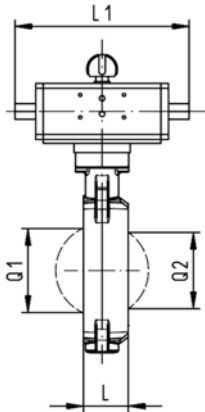
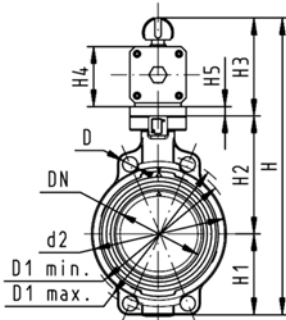

d [mm]	DN [mm]	Inch	PN	kv-value ($\Delta p=1$ bar) [l/min]	EPDM Code
*63	50	2	10	1470	199 240 442
*75	65	2 ½	10	2200	199 240 443
90	80	3	10	3000	199 240 444
110	100	4	10	6500	199 240 445
*140	125	5	10	11500	199 240 446
160	150	6	10	16600	199 240 447
225	200	8	10	39600	199 240 448

d [mm]	Actuator unit type	D [mm]	D1 min. [mm]	D1 max. [mm]	d2 [mm]	H [mm]	H1 [mm]	H2 [mm]	H3 [mm]	H4 [mm]	H5 [mm]	L [mm]
*63	PA-35 DA	19	120.0	125.0	104	317	77	134	107	60	15	45
*75	PA-35 DA	19	139.7	145.0	115	330	83	140	107	60	15	46
90	PA-40 DA	19	150.0	160.0	131	348	89	146	113	66	15	49
110	PA-45 DA	19	175.0	190.5	161	372	104	167	102	71		56
*140	PA-45 DA	23	210.0	215.9	187	408	117	181	111	78		64
160	PA-55 DA	24	241.3	241.3	215	448	130	189	129	86		72
225	PA-55 DA	23	290.0	295.0	267	507	158	210	139	96		73

d [mm]	L1 [mm]	L2 [mm]	Q1 [mm]	Q2 [mm]
*63	177	55	40	
*75	177	55	54	35
90	190	60	67	50
110	235	65	88	74
*140	235	72	113	97
160	279	80	139	123
225	279	90	178	169

Butterfly valves PP-H

Butterfly valve type 567 PP-H Bare shaft

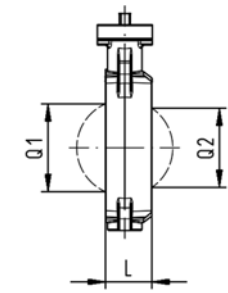
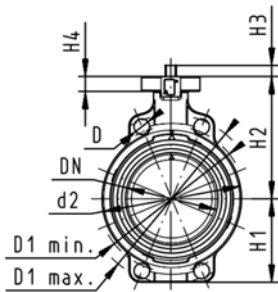

Model:

- Connecting dimension: ISO 7005 PN 10, EN 1092 PN 10, DIN 2501 PN 10, ANSI/ASME B 16.5 Class 150, BS 1560: 1989, BS 4504, JIS B 2220
- Overall length according to EN 558-1, ISO 5752
- Interface F07 for the dimensions DN50-200 according to DIN/ISO 5211
- Interface F10 for the dimensions DN250-300 according to DIN/ISO 5211

d [mm]	DN [mm]	Inch	PN	kv-value ($\Delta p=1$ bar) [l/min]	EPDM Code	FPM Code
63	50	2	10	1470	167 567 802	167 567 822
75	65	2 ½	10	2200	167 567 803	167 567 823
90	80	3	10	3000	167 567 804	167 567 824
110	100	4	10	6500	167 567 805	167 567 825
140	125	5	10	11500	167 567 806	167 567 826
160	150	6	10	16600	167 567 807	167 567 827
225	200	8	10	39600	167 567 808	167 567 828
280	250	10	8	55200	167 567 809	167 567 829
315	300	12	8	80000	167 567 810	167 567 830

d [mm]	D [mm]	D1 min. [mm]	D1 max. [mm]	d2 [mm]	D3 [mm]	D4 [mm]	H [mm]	H1 [mm]	H2 [mm]	H3 [mm]	H4 [mm]	H5 [mm]	L [mm]	Q1 [mm]
63	19	120.0	125.0	104	70	90	222	77	134	27	23	11	45	40
75	19	139.7	145.0	115	70	90	235	83	140	27	23	11	46	54
90	19	150.0	160.0	131	70	90	247	89	146	27	23	11	49	67
110	19	175.0	190.5	161	70	90	287	104	167	16	23	14	56	88
140	23	210.0	215.9	187	70	90	313	117	181	16	23	14	64	113
160	24	241.3	241.3	215	70	90	335	130	189	19	23	17	72	139
225	23	290.0	295.0	267	70	90	387	158	210	19	23	17	73	178
280	25	353.0	362.0	329	102	125	509	205	264	40	23	22	113	210
315	25	400.0	432.0	379	102	125	553	228	285	40	23	22	113	256

d [mm]	Q2 [mm]
63	
75	35
90	50
110	74
140	97
160	123
225	169
280	207
315	253



Butterfly valve type 567 PP-H Hand lever with ratchet settings



Model:

- Connecting dimension: ISO 7005 PN 10, EN 1092 PN 10, DIN 2501 PN 10, ANSI/ASME B 16.5 Class 150, BS 1560: 1989, BS 4504, JIS B 2220
- Overall length according to EN 558-1, ISO 5752
- We recommend for the dimensions DN250 and DN300 only 6 bar maximum system pressure for the hand lever version

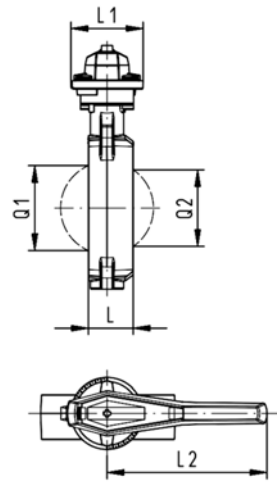
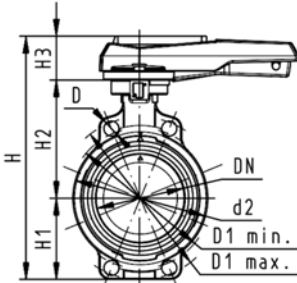

d [mm]	DN [mm]	Inch	PN	kv-value ($\Delta p=1$ bar) [l/min]	EPDM Code	FPM Code
63	50	2	10	1470	167 567 002	167 567 022
75	65	2 1/2	10	2200	167 567 003	167 567 023
90	80	3	10	3000	167 567 004	167 567 024
110	100	4	10	6500	167 567 005	167 567 025
140	125	5	10	11500	167 567 006	167 567 026
160	150	6	10	16600	167 567 007	167 567 027
225	200	8	10	39600	167 567 008	167 567 028
280	250	10	8	55200	167 567 009	167 567 029
315	300	12	8	80000	167 567 010	167 567 030

d [mm]	D [mm]	D1 min. [mm]	D1 max. [mm]	d2 [mm]	H [mm]	H1 [mm]	H2 [mm]	H3 [mm]	L [mm]	L1 [mm]	L2 [mm]	Q1 [mm]	Q2 [mm]
63	19	120.0	125.0	104	264	77	134	54	45	106	205	40	
75	19	139.7	145.0	115	277	83	140	54	46	106	205	54	35
90	19	150.0	160.0	131	289	89	146	54	49	106	205	67	50
110	19	175.0	190.5	161	325	104	167	55	56	106	255	88	74
140	23	210.0	215.9	187	352	117	181	55	64	106	255	113	97
160	24	241.3	241.3	215	373	130	189	55	72	106	255	139	123
225	23	290.0	295.0	267	435	158	210	67	73	140	408	178	169
280	25	353.0	362.0	329	554	205	264	85	113	149	408	210	207
315	25	400.0	432.0	379	598	228	285	85	113	149	408	256	253



Butterfly valve type 567 PP-H Reduction gear with handwheel



Model:

- Connecting dimension: ISO 7005 PN 10, EN 1092 PN 10, DIN 2501 PN 10, ANSI/ASME B 16.5 Class 150, BS 1560: 1989, BS 4504, JIS B 2220
- Overall length according to EN 558-1, ISO 5752

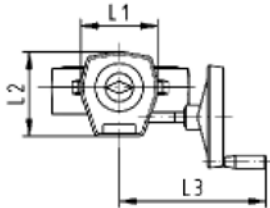
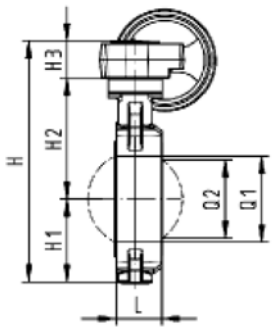
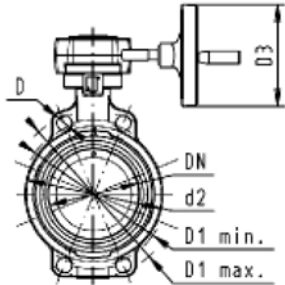

d [mm]	DN [mm]	Inch	PN	kv-value ($\Delta p=1$ bar) [l/min]	EPDM Code	FPM Code
63	50	2	10	1470	167 567 042	167 567 062
75	65	2 ½	10	2200	167 567 043	167 567 063
90	80	3	10	3000	167 567 044	167 567 064
110	100	4	10	6500	167 567 045	167 567 065
140	125	5	10	11500	167 567 046	167 567 066
160	150	6	10	16600	167 567 047	167 567 067
225	200	8	10	39600	167 567 048	167 567 068
280	250	10	8	55200	167 567 049	167 567 069
315	300	12	8	80000	167 567 050	167 567 070

d [mm]	D [mm]	D1 min. [mm]	D1 max. [mm]	d2 [mm]	D3 [mm]	H [mm]	H1 [mm]	H2 [mm]	H3 [mm]	L [mm]	L1 [mm]	L2 [mm]	L3 [mm]	Q1 [mm]
63	19	120.0	125.0	104	160	278	77	134	60	45	120	132	236	40
75	19	139.7	145.0	115	160	291	83	140	60	46	120	132	236	54
90	19	150.0	160.0	131	160	303	89	146	60	49	120	132	236	67
110	19	175.0	190.5	160	160	339	104	167	60	56	120	132	236	88
140	23	210.0	215.9	187	160	365	117	181	60	64	120	132	236	113
160	24	241.3	241.3	215	160	387	130	189	60	72	120	132	236	139
225	23	290.0	295.0	267	160	436	158	210	60	73	120	132	236	178
280	25	353.0	362.0	329	160	529	205	264	60	113	134	151	261	210
315	25	400.0	432.0	379	160	573	228	285	60	113	134	151	261	256

d [mm]	Q2 [mm]
63	
75	35
90	50
110	74
140	97
160	123
225	169
280	207
315	253